

Sellos Mecánicos de Cartucho TSSC-A03 1.000-5.000 (pulgadas)

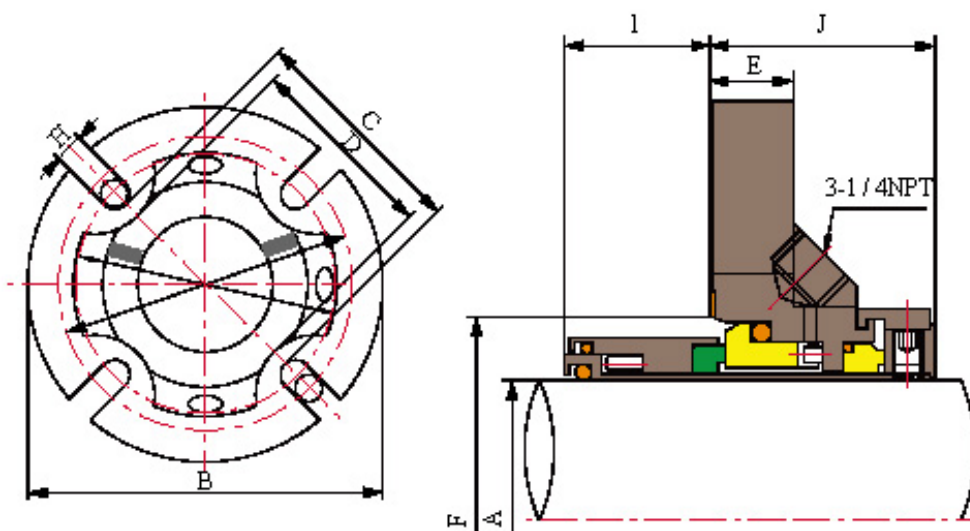

Límites de Funcionamiento

Presión: $\leq 2.3\text{MPa}$

Velocidad: $\leq 16\text{m/s}$

Temperatura: $-30^{\circ}\text{C} \sim 200^{\circ}\text{C}$

Anillo Rotatorio (Carbón/SiC/TC)

Shanghai Trisun Parts Manufacture Co.,Ltd.

Oficina central en Shanghai:

Oficina 05-06, Piso 16th, Edificio Hongjia, Calle Fushan No.388 (Cerca de la Calle Xiangcheng), Pudong, Shanghai, China.

Código Postal: 200122

Tel.: +86-21-58355541, +86-21-58353145, +86-21-58353343

Fax: +86-21-58353141

Correo Electrónico: trisun24@trisunltd.com



Anilla Estacionaria (SiC/TC)
 Sello Secundario (VITON/EPDM/Kalrez)
 Otras Piezas (SUS304/SUS316)

A (mm)	B	C	D	E	F		G		H Máx.	I	J
					Mín.	Máx.	Mín.	Máx.			
24	104.8	54	49.2	13.2	40	46	67	90.5	12	28.6	40.5
25	104.8	54	49.2	13.2	41	49	67	90.5	12	28.6	40.5
28	108	57.2	52.4	13.2	44	52.3	70.3	93.6	12	28.6	40.5
30	111	60.4	55.6	13.2	46	55.5	73.5	96.8	12	28.6	40.5
32	111	60.4	55.6	13.2	48	55.5	73.5	96.8	12	28.6	40.5
33	111	60.4	55.6	13.2	49	55.5	73.5	96.8	12	28.6	40.5
35	111	63.5	58.8	13.2	51	57.5	76.6	96.8	12	28.6	40.5
38	127	71.5	65	16.4	57.2	60.4	85.7	114.3	12	28.6	44.5
40	127	71.5	65	16.4	58	60.4	85.7	114.3	12	28.6	44.5
43	139.7	81	71.4	16.4	61	69.9	95.3	127	12	28.6	44.5
45	139.7	81	71.4	16.4	63.5	69.9	95.3	127	12	28.6	44.5
48	139.7	81	71.4	16.4	66.7	73	95.3	127	12	28.6	44.5
50	152.4	90.5	77.8	16.4	68	76.2	104.8	139.7	12	28.6	44.5
53	152.4	90.5	77.8	16.4	71	76.2	104.8	139.7	12	28.6	44.5
55	165.1	96.8	84.1	16.4	74	82.5	114.3	149.2	16	28.6	44.5
58	165.1	96.8	84.1	16.4	76.2	82.6	114.3	149.2	16	28.6	44.5
60	165.1	96.8	84.1	16.4	79.4	85.7	114.3	149.2	16	28.6	44.5
63	177.8	109.5	96.8	19.6	85.8	92.1	127	160.3	16	31.8	47.7
65	177.8	109.5	96.8	19.6	88.9	95.3	127	160.3	16	31.8	47.7
68	177.8	109.5	96.8	19.6	92.1	98.4	127	160.3	16	31.8	47.7
70	177.8	109.5	96.8	19.6	92.1	98.4	127	160.3	16	31.8	47.7
75	190.5	125.4	108	19.6	98.5	108	142.9	173	16	31.8	47.7
80	190.5	125.4	108	19.6	101.6	111.1	142.9	173	16	31.8	47.7
85	203.2	135	117.5	19.6	108	117.5	155.6	182.5	20	31.8	47.7
90	215.9	150.8	127	19.6	114.3	127	171.5	195.2	20	31.8	47.7
95	215.9	150.8	127	19.6	117.5	130.2	171.5	195.2	20	31.8	47.7
100	228.6	168.3	136.5	19.6	123.9	139.7	188.9	207.9	20	31.8	47.7
105	228.6	168.3	136.5	19.6	130.1	149.2	189	208	20	31.8	47.7
110	241.3	177.8	146.1	19.6	136.5	158.8	198.4	220.6	20	31.8	47.7
115	254	186.6	155.6	19.6	142.9	168.3	211.1	230.2	22	31.8	47.7
120	254	186.6	155.6	19.6	142.9	168.3	211.1	230.2	22	31.8	47.7
125	254	186.6	155.6	19.6	149.2	168.3	211.1	230.2	22	31.8	47.7

Shanghai Trisun Parts Manufacture Co.,Ltd.

Oficina central en Shanghai:

Oficina 05-06, Piso 16th, Edificio Hongjia, Calle Fushan No.388 (Cerca de la Calle Xiangcheng), Pudong, Shanghai, China.

Código Postal: 200122

Tel.: +86-21-58355541,+86-21-58353145,+86-21-58353343

Fax: +86-21-58353141

Correo Electrónico: trisun24@trisunltd.com